

GUTTER GUARD INSTALLATION INSTRUCTIONS AND PROCEDURES

Thank you for purchasing our raised screen pattern gutter guards, one of the top performing gutter guards on the market! Step-by-step instructions make this product perfect for any Do-It-Yourselfer. Carefully review the installation instructions and procedures prior to installing your gutter guards. Additional information (Disponible en Español) and how-to instructional videos can be found by scanning the QR code or going to the website: www.gutterguardinstructions.com.

!!! When installing gutter guards, safety must be your top priority. Only use the proper tools and personal protection equipment (PPE) in a safe manner as intended. Verify tools and equipment are in a safe working condition before proceeding. !!!

Tools:

Depending upon your gutter guard system and home layout, the following tools are either necessary or recommended for your installation.

- PPE (Safety glasses, gloves, etc)
- Properly sized ladder in safe working condition
- Power drill or impact driver
- ¼ inch nut setter
- Self-Tapping Hex Screws
- Measurement and marking tools
- Sheet metal snips (Aviation and straight cut)
- Silicone Caulk (Exterior rated)
- Sheet metal clamp or hand seamer
- Gutter scoop and bucket

Keys For Success:

- Clean your gutters and down spouts before installing your gutter guards. This can be done section by section as you install your gutter guards, reducing the number of trips up and down the ladder. Any debris left in the gutters will remain in the gutters after installation.
- Installing the gutter guards at an angle will allow the wind to potentially blow off debris & leaves or “naturally self-clean”. Installing gutter guards flat can lead to build-up.
- Begin by installing all corners and end caps first, then fill in the gap in between.
- Adding silicone caulking to seal the end mesh or fill in any small gaps will help keep debris out and deter insects from nesting in the gutter.

Installing Your New Gutter Guards:

First, identify the proper method for installing gutter guards to your home. Your tile/shingle system and gutter mounting position will dictate which method is best for your application. There are two methods: Under Shingle or Fascia. Details for both processes are outlined below. It is critical to pick the proper method to avoid damaging the integrity of your home from water damage.

Under the Shingle Method:

This method requires the rear rail of the gutter guard to be installed between the roof shingle and the moisture barrier. The rear rail guard is supported by the roof deck and held down by the shingle. The front rail of the guard is attached to the front lip of the gutter.

1. Lift the roof shingle up just enough to slide the rear rail of the gutter guard in and rest on top of the moisture barrier. Take care not to damage or cut the moisture barrier.
2. Pull the gutter guard forward until front lip of the guard is in contact of the lip of the gutter as shown in Figure 1.
3. Using the magnetic nut setter to and self-tapping hex screws, secure the guard to the front lip of the gutter. Screws should be installed in the pre-drilled holes, or every 12-18 inches as needed.

Figure 1: Under Shingle Method

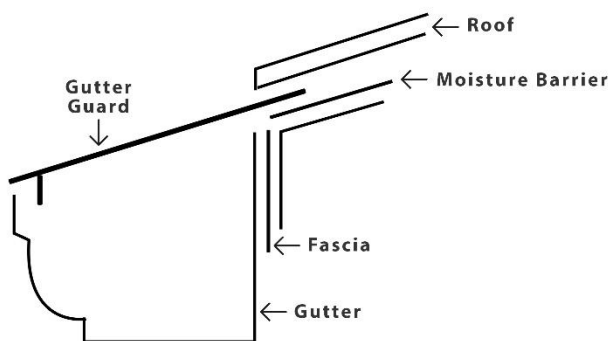

Fascia Method:

This method requires the rear rail to be bent either upward or downward at an 90° angle relative to the fascia or rafter board so the guard can be secured with a screw. This bend must extend the whole length of the gutter guard. Bend the rear rail up if the gutter sits 1 inch or greater below the roof line. For gutters hung less than 1 inch from the roof line, the rear rail should be bent downward.

The gutter guard is then fitted over the gutter open area, just under the roof shingle as shown in Figure 2 by installing a screw into the front rail and the gutter lip, then installing a screw in the back rail into the fascia board.

Bending The Rear (Back) Rail For Fascia Method:

1. Measure the rain gutter opening from the face of the fascia board to the edge of the rain gutter's front inside lip.
2. On the underside of the gutter guard, mark the measurement 1/8 inch less than the actual length measured starting from front rail stop towards the back.

Example: If you measure 4 inches, mark it at 3 7/8 inch, giving you a 1/8 inch bend which will bring the overall measurement to 4 inches.

Bending the back rail/mesh area to a 90° angle can be achieved in several different ways. Using sheet metal clamps or seamer hand tools is most common. An impromptu press brake can be created using two 5 ft. pieces of 1 x 2 inch boards and some clamps to pinch and bend the material.

Figure 2: Fascia Method

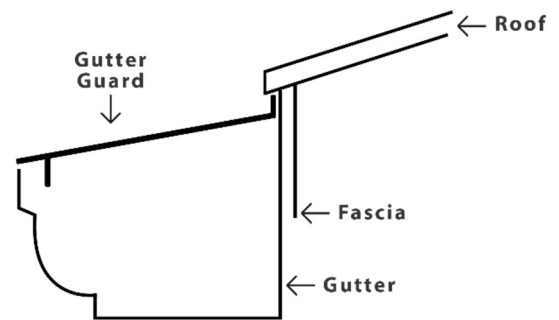

Cutting the Gutter Guard:

Straight Cut or Outside Cut:

Using sheet metal snips:

1. Mark a cut line along the full width of the part. Measure an additional 1/2 inch for the mesh to create an overlap piece when joining the two end seam sections. Refer to Figure 3 for an example.
2. Start by cutting the front rail, then the back rail, followed by the mesh screen.

Figure 3: Cut and Overlap Seam Example

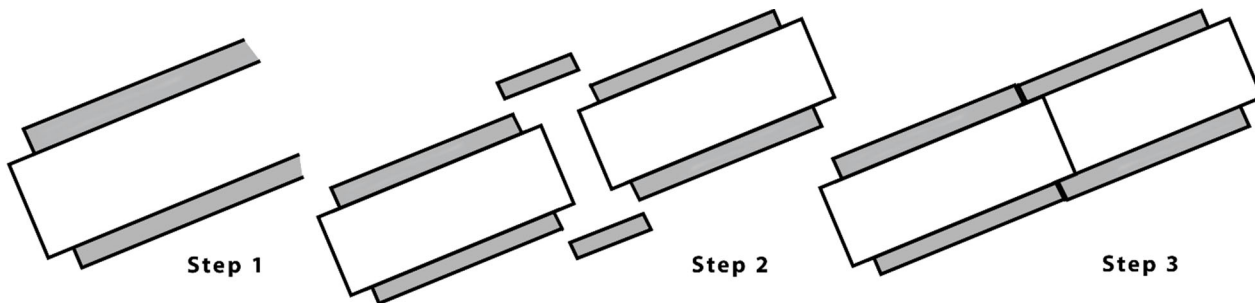

Inside Corner Cut:

When flat, a 45° angle is used, but as the slope increases, the cut angle on the gutter guard decreases.

Example: on a 4/12 pitch roof, cut at a 43° angle. This allows the gutter guard rail to move closer together keeping a good seal while the roof angle decreases.

Outside Corner Cut:

When flat, a 45° angle is used, but as the slope increases, the cut angle on the gutter guard increases.

Example: on a 4/12 pitch roof, cut it at a 48° angle. This allows the gutter guard rail to move farther apart, keeping a good seal while the roof angle increases.

End Cap Installation:

There are several ways to make "end-caps" to cap the ends. Most commonly this is done with following method.

1. Cut 2 inches off both the front and back rails only, leaving an extra 2 inches of only the mesh screen. The front rail of the gutter guard should be flush with the end of the gutter when installed.
2. Fold the mesh downward at a 90° angle and install the gutter guard with the screen trimmed to fit as the end cap.
3. Bend the endcap's mesh to form as much of a screen between the fascia board and the perimeter of the gutter. Secure and seal using silicone caulk, in addition to filling in any gaps.